

## 50.0MM TRIPLE BLACK

<b>Status</b>	Production
<b>Part no.</b>	10293
<b>Drawing no.</b>	60443
<b>No. of optics</b>	3
<b>No. of legs</b>	3
<b>Pin length</b>	4.3
<b>Related Optics</b>	10194 20.0 mm Frosted Narrow Catadioptic 10195 20.0 mm Frosted Medium Catadioptic 10209 20.0 mm Ripple Wide Catadioptic 10196 20.0 mm Frosted Wide Catadioptic 10197 20.0 mm Elliptical Catadioptic 10198 20.0 mm Elliptical Orthogonal Catadioptic 10208 20.0 mm Ripple Medium Catadioptic 10193 20.0 mm Plain Tight Catadioptic
<b>Related LEDs</b>	SSC P4 SSC P4
<b>Files</b>	<a href="#">Customer drawing (PDF)</a>

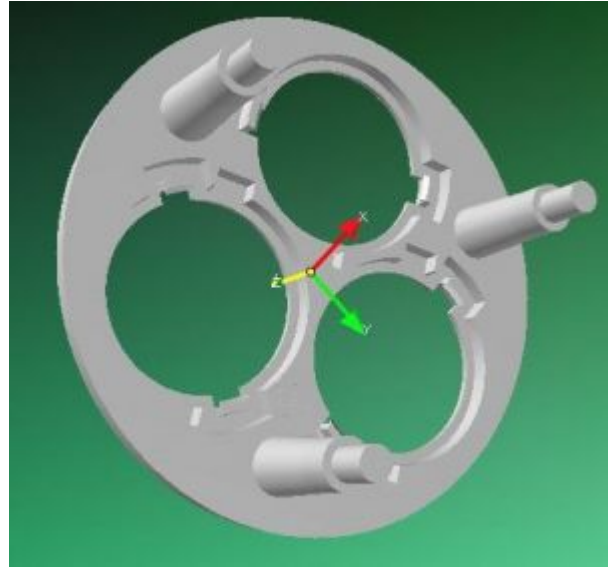

Carclo Technical Plastics endeavours to continuously improve and renew its products; for this reason the technical data and contents of this catalogue may undergo variations without prior notice. For correct and up to date information, Carclo suggest using the Opticselect tool on our website <http://www.carclo-optics.com>.  
Copyright © Carclo 2010

### Handling instructions

- Do not handle or install lenses without wearing gloves, skin oils may damage the lens or the light transmission.
- Clean lenses with a mild soap and water and dry with a clean soft cloth.
- Do not use any commercial solvents on lenses.
- Mount holders with low Odour epoxy's and allow time for them to out gas to stop lenses fogging.

Please note that flow lines, weld lines, surface scratches and small black or white inclusions within the lenses are acceptable if the optical performance of the lens is within the specification described to +/-10%. FWHM-Full (beam) Width as measured at one Half of Maximum intensity, information shown in the catalogue are based on our laboratory's tests.

All rights reserved. No part of this publication may be copied, reproduced in any form or by any means, electronic, mechanical, photocopying, recording or otherwise, illustrations not to be removed, without our prior permission. Carclo Technical Plastics reserves the right to make changes at any time in order to supply the best products possible.

R1 IN 6 POSNS.

10.4

1.3

Y

7.6