

配件 (FITTINGS):

- MG104C5A-09
- MG104C5A-10
- MGCG6A
- MGC6B
- 铜壳
- 铁壳
- OTHER

Fit for 24/26 AWG cable, but detailed will depend on the actual wire and cable.

Inspection for Environmental Protection:

Based on the performed tests on submitted sample, the test results are Compliant with the limits of RoHS and REAC

Electrical Test:

- A. 250V AC max, at 2A.
- B. Dielectric withstanding 1000V DC/min, <0.5A.
- C. Insulation Resistance: >500 MΩ, 1000V DC/min.
- D. Contact Resistance: <20 MΩ.

Mechanical:

- A. Cable-to-plug tensile strength-20 LBS (89N) min.
- B. Durability: 2000 mating cycles.

Operating Temperature: -40°C ~ +125°C.

环保测试:

通过RoHS、REACH之安全物质使用的检验标准。

电气特性:

- A. 250伏特AC, 最大2安培耐电压伏特数。
- B. 耐电压测试: 小于0.5安培 1000伏特DC/一分钟。
- C. 绝缘抗阻: 1000伏特DC/一分钟, 大于500百万欧姆。
- D. 接触阻抗: 不大于20毫欧姆。

机械特性:

- A. 拉力测试: 电缆至插座张力强度至少一分钟20磅 (89N)。
- B. 耐力测试: 插拔测试2000次以上。

使用温度范围: -40°C ~ +125°C

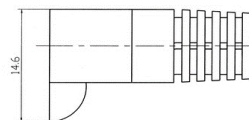
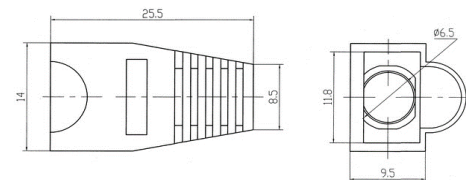

TOLERANCE: ±0.1

Note: (Colour Codes)

- Blue RAL 5005
- Yellow RAL 1003
- Red RAL 3020
- Green RAL 6024
- White RAL 9003
- Black RAL 9005
- Grey RAL 7044 (standard)

1	CONNECTORS	RJ 45 PLUG, GOLD PLATET WITH ST. PROTECTOR + INSERT.
2	MOLDING	
3	CABLE	
NO	PART NAME	



S-Conn Handels GmbH  
Am Mühlberg 8  
91477 Markt Bibart  
Tel. 09162/ 98 93 8-0  
Fax 09162/ 98 93 8-20  
info@s-conn.de

www.s-conn.de

DESCRIPTION		RJ45 PLUG 8 PINS, 8 CONTACTS WITH STAIN PROT. + INSERTION					
SIZE	A4	DATE		CHECKED		TOL	72057
UNIT	MM	DRAWN		APPROVED			
CUSTOM TARIF NO.: 85366990990							



