

COPYRIGHT © Hangzhou EZVIZ Software Co., Ltd. ALL RIGHTS RESERVED.

Any and all information, including, among others, wordings, pictures, graphs are the properties of Hangzhou EZVIZ Software Co., Ltd. (hereinafter referred to as “EZVIZ”). This user manual (hereinafter referred to as “the Manual”) cannot be reproduced, changed, translated, or distributed, partially or wholly, by any means, without the prior written permission of EZVIZ. Unless otherwise stipulated, EZVIZ does not make any warranties, guarantees or representations, express or implied, regarding to the Manual.

About this Manual

The Manual includes instructions for using and managing the product. Pictures, charts, images and all other information hereinafter are for description and explanation only. The information contained in the Manual is subject to change, without notice, due to firmware updates or other reasons. Please find the latest version in the EZVIZ™ website (<http://www.ezviz.com>).

Revision Record

New release – January, 2023

Trademarks Acknowledgement

EZVIZ™, ™, and other EZVIZ's trademarks and logos are the properties of EZVIZ in various jurisdictions. Other trademarks and logos mentioned below are the properties of their respective owners.

Legal Disclaimer

TO THE MAXIMUM EXTENT PERMITTED BY APPLICABLE LAW, THE PRODUCT DESCRIBED, WITH ITS HARDWARE, SOFTWARE AND FIRMWARE, IS PROVIDED “AS IS”, WITH ALL FAULTS AND ERRORS, AND EZVIZ MAKES NO WARRANTIES, EXPRESS OR IMPLIED, INCLUDING WITHOUT LIMITATION, MERCHANTABILITY, SATISFACTORY QUALITY, FITNESS FOR A PARTICULAR PURPOSE, AND NON-INFRINGEMENT OF THIRD PARTY. IN NO EVENT WILL EZVIZ, ITS DIRECTORS, OFFICERS, EMPLOYEES, OR AGENTS BE LIABLE TO YOU FOR ANY SPECIAL, CONSEQUENTIAL, INCIDENTAL, OR INDIRECT DAMAGES, INCLUDING, AMONG OTHERS, DAMAGES FOR LOSS OF BUSINESS PROFITS, BUSINESS INTERRUPTION, OR LOSS OF DATA OR DOCUMENTATION, IN CONNECTION WITH THE USE OF THIS PRODUCT, EVEN IF EZVIZ HAS BEEN ADVISED OF THE POSSIBILITY OF SUCH DAMAGES.

TO THE MAXIMUM EXTENT PERMITTED BY APPLICABLE LAW, IN NO EVENT SHALL EZVIZ'S TOTAL LIABILITY FOR ALL DAMAGES EXCEED THE ORIGINAL PURCHASE PRICE OF THE PRODUCT.

EZVIZ DOES NOT UNDERTAKE ANY LIABILITY FOR PERSONAL INJURY OR PROPERTY DAMAGE AS THE RESULT OF PRODUCT INTERRUPTION OR SERVICE TERMINATION CAUSED BY: A) IMPROPER INSTALLATION OR USAGE OTHER THAN AS REQUESTED; B) THE PROTECTION OF NATIONAL OR PUBLIC INTERESTS; C) FORCE MAJEURE; D) YOURSELF OR THE THIRD PARTY, INCLUDING WITHOUT LIMITATION, USING ANY THIRD PARTY'S PRODUCTS, SOFTWARE, APPLICATIONS, AND AMONG OTHERS.

REGARDING TO THE PRODUCT WITH INTERNET ACCESS, THE USE OF PRODUCT SHALL BE WHOLLY AT YOUR OWN RISKS. EZVIZ SHALL NOT TAKE ANY RESPONSIBILITIES FOR ABNORMAL OPERATION, PRIVACY LEAKAGE OR OTHER DAMAGES RESULTING FROM CYBER ATTACK, HACKER ATTACK, VIRUS INSPECTION, OR OTHER INTERNET SECURITY RISKS; HOWEVER, EZVIZ WILL PROVIDE TIMELY TECHNICAL SUPPORT IF REQUIRED. SURVEILLANCE LAWS AND DATA PROTECTION LAWS VARY BY JURISDICTION. PLEASE CHECK ALL RELEVANT LAWS IN YOUR JURISDICTION BEFORE USING THIS PRODUCT IN ORDER TO ENSURE THAT YOUR USE CONFORMS TO THE APPLICABLE LAW. EZVIZ SHALL NOT BE LIABLE IN THE EVENT THAT THIS PRODUCT IS USED WITH ILLEGITIMATE PURPOSES.

IN THE EVENT OF ANY CONFLICTS BETWEEN THE ABOVE AND THE APPLICABLE LAW, THE LATTER PREVAILS.

Table of Contents

Overview	1
1. Package Contents	1
2. Basics	2
Get the EZVIZ App	3
For First Use	3
1. Lithium Battery Charging	3
2. Power On Settings	4
Installation	4
Wall/Door Mount	4
Desktop Placement	7
Add to EZVIZ App	8
Operations on the EZVIZ App	9
1. Live View	9
2. Settings	10
Specifications	11
FAQ	11
Rechargeable Lithium ion Battery	11
Initiatives on the Use of Video Products	12
INFORMATION FOR PRIVATE HOUSEHOLDS	13

Overview

1. Package Contents



Device (x1)



Power Cord(x1)



Wall Mount Bracket (x1)



Desktop Bracket (x1)

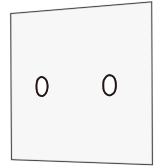

3M Sticker (x1)



Screw Kit (x1)

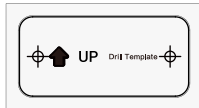

Drilling Template(x1)



Regulatory Information (x1)



Quick Start Guide (x1)

 All component's appearance is subject to the one you have bought.

2. Basics

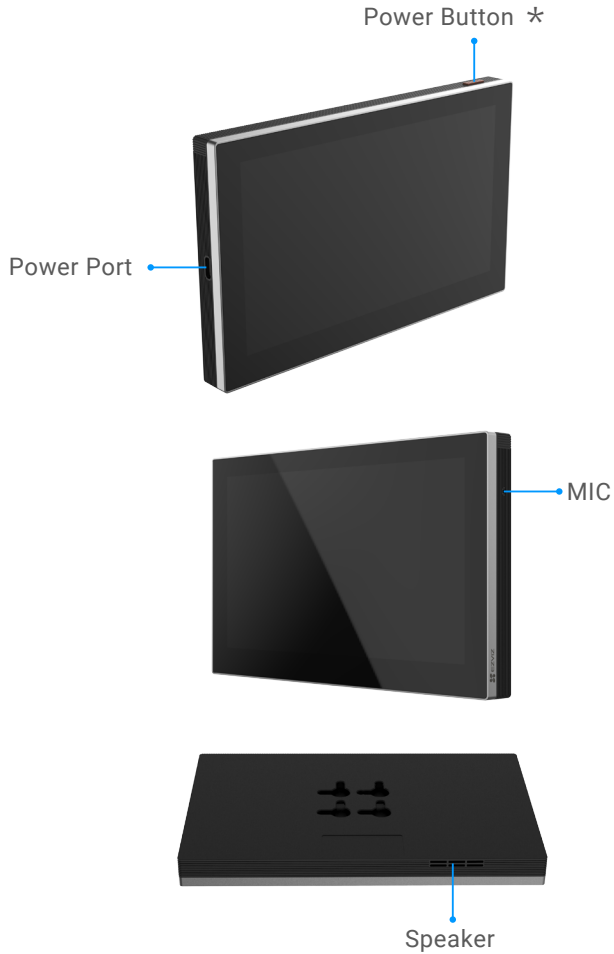

i When in use, please press the corresponding keys on bottom of the device.

* Power Button

Press Once (Under Wake State)	On / Off backlight
Press and hold for 3s (Under Wake State)	Shutdown / startup the screen by touching screen
Press Once (Under Sleep Mode)	Wake and light the screen
Press and hold for 3s (Under Off Mode)	Startup
Press and hold for 12s (Under On Mode)	Force restart

Get the EZVIZ App

1. Connect your mobile phone to Wi-Fi (suggested).
2. Download and install the EZVIZ app by searching for "EZVIZ" in the App Store or Google Play™.
3. Launch the app and register an EZVIZ user account.

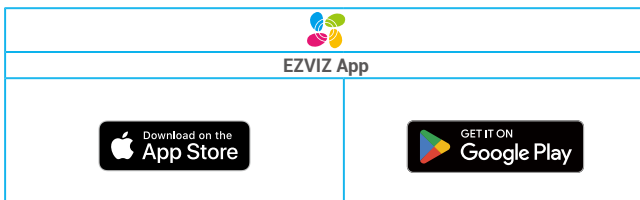

- i** If you have already used the app, please make sure that it is the latest version. To find out if an update is available, go to the app store and search for "EZVIZ".

For First Use

For first time use, please operate by the following steps.

1. Lithium Battery Charging

Connect device to power outlet with the power adapter (purchase separately) for charging(5V 2A), you can view the battery power on screen interface.

- i** The device is equipped with a 4600mAh rechargeable lithium battery. For optimal performance, please use the original adapter to charge the battery."

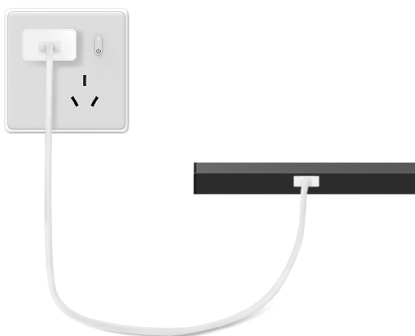

2. Power On Settings

Make sure that the screen has sufficient battery power before powering it on, and then finish Wi-Fi network configuration and device accessing, such as door lock, doorbell, camera and so on.

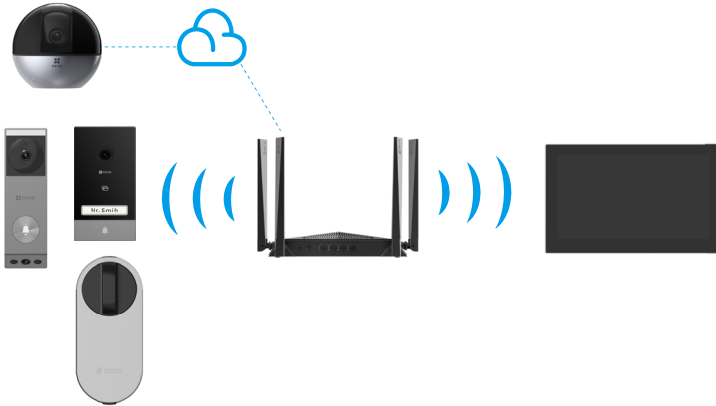

i Devices under the same account can be connected to the screen regardless of whether they are on the same local network.

Installation

Wall/Door Mount

1. Install Wall Mount Bracket

If you fix the bracket with screw kit

- Select an appropriate position;
- Attach the drilling template onto a clean and flat surface
- (For cement wall only) Drill screw holes according to the template, and insert anchors;
- Use screws to fix the wall mount bracket on the installation surface.

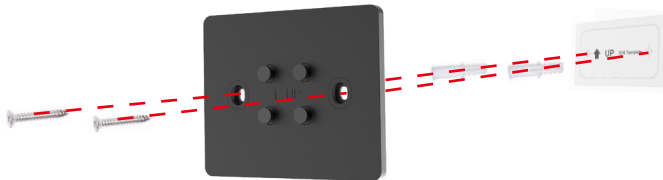

If you fix the bracket with 3M sticker.

- i** Please ensure the following installation conditions are satisfied:
- The wall or door to be mounted shall be clean and dry without any dirty like oil stain or dust. If there are dirty on wall or door, please swipe with alcohol, and attach the 3M sticker after the alcohol is completely evaporated.
 - The wall or door to be mounted shall be flat for a fully contact between 3M sticker with the installation surface, so that ensure a excellent paste effect.
- Before attaching the wall mount bracket to the wall or door, it is necessary to apply a force of approximately 10 kg to the wall mount bracket for 30s to ensure the double-sided adhesive can bond firmly.
Recommended for use on iron surfaces instead of on painted walls.
Please wait for 24h after attaching the 3M sticker, and then assembly the screen on the wall mount bracket to use.

1. Attach the 3M sticker onto the back of the wall mount bracket.
2. Put the assembled wall mount bracket on the installation surface.

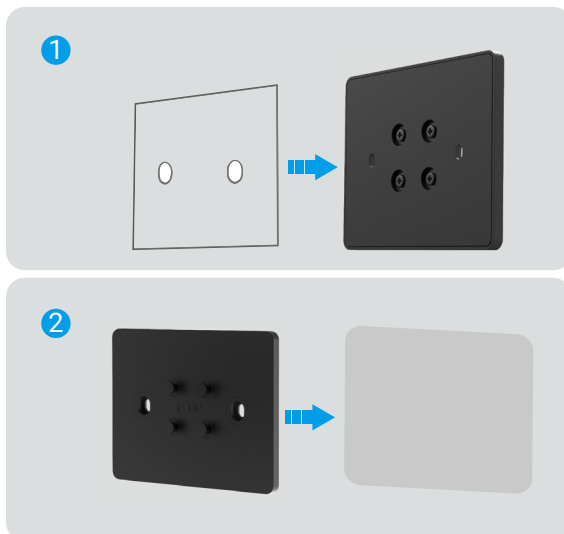

3. Align the hanging grooves on the back of the device with the positioning pins on the wall mount bracket and insert it.
4. Slide the device downward to ensure a firmly assembly.

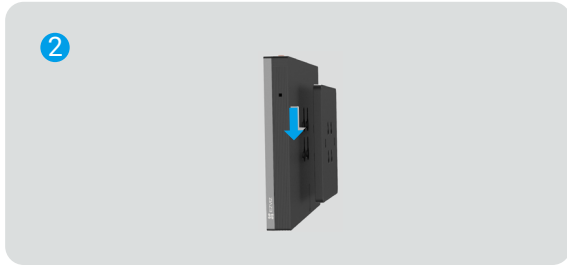
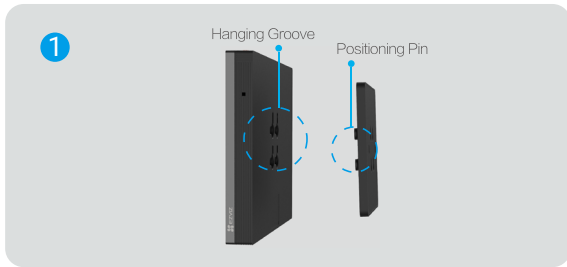

5. You can switch landscape or portrait as needed.

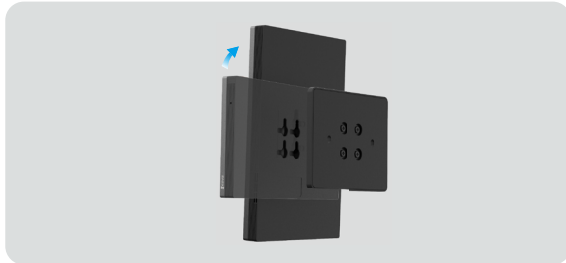

i For a better experience, recommended to use portrait mode when connecting to the video lock.

Desktop Placement

1. Align the hanging grooves on the back of the device with the positioning pins on the wall mount bracket and insert it.
2. Slide the screen downward to ensure a firmly assembly.

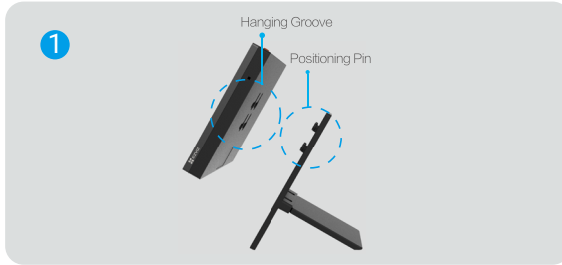

3. You can switch landscape or portrait as needed.



- 1 For a better experience, recommended to use portrait mode when connecting to the video lock.

Add to EZVIZ App

- Log in to your account using the EZVIZ App.
 - Complete network connection according to the interface guidance.
 - On App Home screen, tap “+” on the upper-right corner to go to the Scan QR Code interface.
 - Scan the QR code on the Quick Start Guide cover or on label of the Screen body or on the screen of the device.
- i**
- Please keep the QR code information properly. It is recommended taking a photo for future reference.
 - You can view the QR code on startup guidance interface, or operate on the Screen to enter into **Device Information**.



- Follow the EZVIZ app wizard to add the device to the app.

Operations on the EZVIZ App

i The app interface may be different due to version update, and the interface of the app you installed on your phone shall prevail.

1. Live View

When you launch the EZVIZ App, the device page displays as shown below.

You can view the linked devices in the channel, watch a live feed, take snapshots, record videos, or choose video definition as needed.

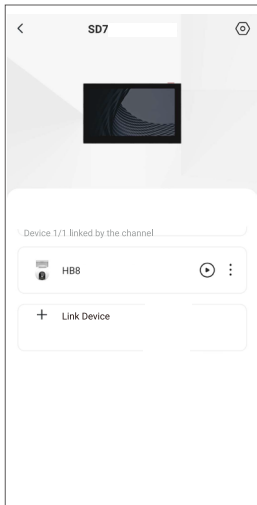

Icon	Description
	Settings. View or change the screen settings.
	Play. Tap to play the live view of the corresponding device on the screen.
	Edit. Tap to view the detailed information of the linked devices.

2. Settings

Parameter	Description
Notification	You can manage the EZVIZ App notification.
Audio Settings	You can set relevant audio parameters for your device.
Screen Settings	You can set screen brightness and auto-lock-screen time here.
Battery	You can see the battery remaining capacity here.
Network Settings	You can see the connection status.
Device Information	You can see the screen information here, like space, type, serial number, device version and user guide.
More	You can transfer the device or authorize on your screen.
Restart Device	Tap to restart the device.
Delete Device	Tap to delete the screen from EZVIZ App.

Specifications

Rated Input	5V == 2A
Working Temperature	0°C ~ 40°C
Working Humidity	0~95%
Screen Parameters	7 inch

FAQ

Q:	Does the screen support a long-time continuous work?
A:	The screen will be sleep automatically after no operations for a certain time.
Q:	Does the screen support Wi-Fi access network?
A:	It supports 2.4G Wi-Fi or Dual-band integration Wi-Fi.
Q:	Can the screen be used as an ordinary display?
A:	The Screen can only be used as a smart screen.

 For additional information about the Screen, please refer to www.ezviz.com/eu.

Rechargeable Lithium ion Battery

Chemical Composition	Chemical Formula	CAS No.	Weight(%)
Lithium Cobalt Oxide	LiCoO ₂	12190-79-3	47.29%
Nanotubes	CNT	1333-86-4	0.46%
Polyvinylidene fluoride	PVDF	24937-79-9	0.52%
Aluminum Foil	AL	7429-90-5	5.01%
Copper Foil	Cu	7440-50-8	7.35%
Graphite	C	7782-42-5	25.01%
Super P	S-P	7782-42-5	0.24%
Styrene Butadiene rubber	SBR	61789-96-6	0.95%
Carboxymethylcellulose Sodium	CMC	9000-11-7	0.40%
Polypropylene	(C ₂ H ₄) _n	9002-88-4	0.30%

Initiatives on the Use of Video Products

Thank you for choosing EZVIZ products.

Technology affects every aspect of our life. As a high-tech company, we are increasingly aware of the role technology plays in improving business efficiency and quality of life, but at the same time, the potential harm of its improper usage. For example, video products are capable of recording real, complete and clear images. This provides a high value in retrospect and preserving real-time facts. However, it may also result in the infringement of a third party's legitimate rights and interests if improper distribution, use and/or processing of video data takes place. With the philosophy of "Technology for the Good", EZVIZ requests that every end user of video technology and video products shall comply with all the applicable laws and regulations, as well as ethical customs, aiming to jointly create a better community.

Please read the following initiatives carefully:

1. Everyone has a reasonable expectation of privacy, and the installation of video products should not be in conflict with this reasonable expectation. Therefore, a warning notice shall be given in a reasonable and effective manner and clarify the monitoring range, when installing video products in public areas. For non-public areas, a third party's rights and interests shall be evaluated when installing video products, including but not limited to, installing video products only after obtaining the consent of the stakeholders, and not installing highly-invisible video products.

2. The purpose of video products is to record real activities within a specific time and space and under specific conditions. Therefore, every user shall first reasonably define his/her own rights in such specific scope, in order to avoid infringing on a third party's portraits, privacy or other legitimate rights.

3. During the use of video products, video image data derived from real scenes will continue to be generated, including a large amount of biological data (such as facial images), and the data could be further applied or reprocessed. Video products themselves could not distinguish good from bad regarding how to use the data based solely on the images captured by the video products. The result of data usage depends on the method and purpose of use of the data controllers. Therefore, data controllers shall not only comply with all the applicable laws and regulations and other normative requirements, but also respect international norms, social morality, good morals, common practices and other non-mandatory requirements, and respect individual privacy, portrait and other rights and interests.

4. The rights, values and other demands of various stakeholders should always be considered when processing video data that is continuously generated by video products. In this regard, product security and data security are extremely crucial. Therefore, every end user and data controller, shall undertake all reasonable and necessary measures to ensure data security and avoid data leakage, improper disclosure and improper use, including but not limited to, setting up access control, selecting a suitable network environment (the Internet or Intranet) where video products are connected, establishing and constantly optimizing network security.

5. Video products have made great contributions to the improvement of social security around the world, and we believe that these products will also play an active role in more aspects of social life. Any abuse of video products in violation of human rights or leading to criminal activities are contrary to the original intent of technological innovation and product development. Therefore, each user shall establish an evaluation and tracking mechanism of their product application to ensure that every product is used in a proper and reasonable manner and with good faith.

INFORMATION FOR PRIVATE HOUSEHOLDS

1. Separate collection of waste equipment: Electrical and electronic equipment that has become waste is referred to as waste equipment. Owners of waste equipment must dispose of it separately from unsorted municipal waste. In particular, waste equipment does not belong in household waste, but in special collection and return systems.

2. Batteries and rechargeable batteries as well as lamps: Owners of waste equipment shall, as a rule, separate waste batteries and rechargeable batteries that are not enclosed in the waste equipment, which can be removed from the waste equipment without being destroyed, from the waste equipment before handing them in at a collection point. This does not apply if waste equipment is prepared for reuse with the participation of a public waste management authority.

3. Options for returning waste equipment: Owners of waste equipment from private households can return it free of charge to the collection points of the public waste management authorities or to the take-back points set up by manufacturers or distributors within the meaning of the Electrical and Electronics Equipment Law. Stores with a sales area of at least 400 m² for electrical and electronic equipment and those grocery stores with a total sales area of at least 800 m² that offer electrical and electronic equipment several times a year or on a permanent basis and make it available in the market are required to take it back. This also applies in the case of distribution using means of distance communication, if the storage and shipping areas for electrical and electronic equipment are at least 400 m² or the total storage and shipping areas are at least 800 m². Distributors shall, in principle, ensure take-back by providing suitable return facilities at a reasonable distance from the respective end user. The possibility of returning waste equipment free of charge exists for distributors who are obliged to take it back, among other things, if a new similar device that essentially fulfills the same functions is delivered to an end user.

4. Privacy Notice: Waste equipment often contains sensitive personal data. This applies in particular to devices of information and telecommunications technology such as computers and smartphones. In your own interest, please note that each end user is responsible for deleting the data on the waste equipment to be disposed of.

5. Meaning of the symbol “crossed-out wheelee bin”: The symbol of a crossed-out wheelee bin regularly depicted on electrical and electronic equipment indicates that the respective device is to be collected separately from unsorted municipal waste at the end of its service life.