

OP1

.....

Smart Outdoor Pan&Tilt Camera QUICK GUIDE



Quick start guide

1. Packing list
2. Product description
3. Installation
4. Product configuration
5. Specification
6. Legal notice

1. Packing list



Camera X1



Power adaptor X1



Type-C cable X1



Bracket X1



Screw package X1



Quick guide X1



Silicone plug for power cable X1



Silicone plug for power cable

2. Product description

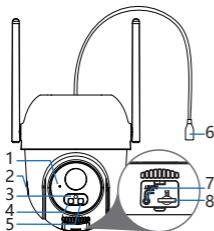

1. Microphone
2. Speaker (back)
3. LED indicator
4. White light
5. IR light
6. Micro USB
7. Reset
8. SD card slot

Notice

To reset the device, press and hold the reset button for 5s. The camera beeps when the operation is completed.

LED indicator of camera:

Flashing red light (slow)	Wait for network config
Flashing red light (fast)	Connecting the network
Fixed red light	Camera is malfunctional
Fixed blue light	Camera network is normal

3. Installation

Wall Mounting

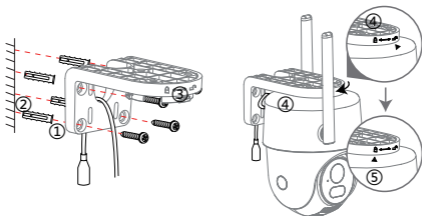

1. Take camera power cable through the bracket.
- 2/3. Install expansion screws and mounting screws.
4. Insert the camera into the bracket and point the camera black arrow at the bracket Unlock logo.
5. Rotate the camera until it snaps into the bracket with the black arrow pointing at the Lock logo.

Cell Mounting

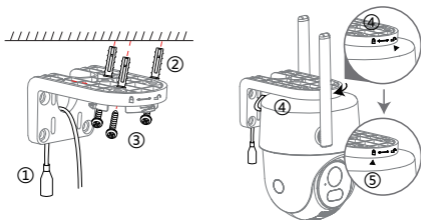

1. Take camera power cable through the bracket.
- 2/3. Install expansion screws and mounting screws.
4. Insert the camera into the bracket and point the camera black arrow at the bracket Unlock logo.
5. Rotate the camera until it snaps into the bracket with the black arrow pointing at the Lock logo.

4. Product configuration

Scan QR code to download and install the Arenti APP.
You can also search "Arenti" on App Store (IOS) or Play Store (Android).



Registration

Open the App. If you are a new user, tap to create a account and follow the prompts to complete setup.

Note: You must agree with the Privacy Agreement.

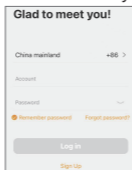

Pairing

Open APP home page, Click "+" or "Add" and select icon according to actual camera.

Power on the device. For about 30 seconds, camera will emit start-up tone and LED indicator will flash red slowly.

Note: When pairing, please put the camera and mobile phone close to the router. If camera is not in the red slow blinking after 30 seconds of powering on, press and hold the reset button for 5 seconds to reset, and then configure the network again.

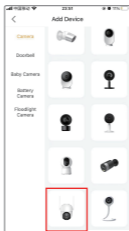

support@arenti.com

Select the Wi-Fi network and input the password, and then click "Next". Make sure that phone has connected to a fluent and steady Wi-Fi already.

Scan the QR code in your phone with the camera and click "Next", when the camera comes out "dong dong dong" and LED indicator becomes solid blue.

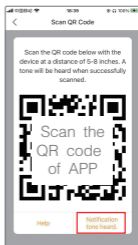

If no device is found and the pairing process is not successful, please check below instructions:

1. Wi-Fi network is 2.4GHz/5GHz.
2. Wi-Fi password entered is correct and the same Wi-Fi network is used on the mobile device.
3. Camera is in pairing mode.
4. Check your WiFi for network activity.

Notice

If you have multiple cameras, please follow steps again to add one by one. To change Wi-Fi network, please restore the camera to factory settings and add again.

5. Specification

Product name	OP1
Resolution	2560 x 1440
Angle of view	95°
IR Distance	Up to 10m
Pan/Tilt	0°~355° (Pan); 0°~90° (Tilt)
Working temp	-20°C to 50°C
Local storage	Micro SD card (up to 128GB)
Power	DC 5V, 1A
Consumption	Up to 2.5W
Supported phone OS	iOS 9/Android 5.0 and above version
Wireless connection	IEEE802.11 a/b/g/n (2.4GHz&5GHz)

6. Legal notice

Support www.arenti.com

Symbols  Direct current (DC)



Don't throw batteries or out of order products with the household waste (garbage). The dangerous substances that they are likely to include may harm health or the environment. Make your retailer take back the products or use selective collect of garbage proposed by your city.



Hereby, we declares that the radio equipment type 'OP1' is in compliance with the Directive 2014/53/EU

The full test of the EU declaration of conformity is available at the following Internet address:

www.arenti.com



FCC Statement

This equipment has been tested and found to comply with the limits for a Class B digital device, pursuant to part 15 of the FCC Rules. These limits are designed to provide reasonable protection against harmful interference in a residential installation. This equipment generates, uses and can radiate radio frequency energy and, if not installed and used in accordance with the instructions, may cause harmful interference to radio communications. However, there is no guarantee that interference will not occur in a particular installation. If this equipment does cause harmful interference to radio or television reception, which can be determined by turning the equipment off and on, the user is encouraged to try to correct the interference by one or more of the following measures:

- Reorient or relocate the receiving antenna.
- Increase the separation between the equipment and receiver.
- Connect the equipment into an outlet on a circuit different from that to which the receiver is connected.
- Consult the dealer or an experienced radio/TV technician for help.

FCC Radiation Exposure Statement

This device complies with FCC radiation exposure limits set forth for an uncontrolled environment and it also complies with Part 15 of the FCC RF Rules. This equipment must be installed and operated in accordance with provided instructions and the antenna(s) used for this transmitter must be installed to provide a separation distance of at least 20 cm from all persons and must not be co-located or operating in conjunction with any other antenna or transmitter. End-users and installers must be provide with antenna installation instructions and consider removing the no-collocation statement.

This device complies with Part 15 of the FCC Rules. Operation is subject to the following two conditions: (1) this device may not cause harmful interference, and (2) this device must accept any interference received, including interference that may cause undesired operation.

Caution!

Any changes or modifications not expressly approved by the party responsible for compliance could void the user's authority to operate the equipment.

© 2023. All rights reserved. All trade names are registered trademarks of respective companies Apple, the Apple logo, iPhone are trademarks of Apple Inc. registered in the U.S. and other countries. Google, the Google logo, Android are trademarks of Google Inc. App Store is a service mark of Apple Inc. Google Play is a service mark of Google Inc.