	Model specification	Base type	Emitted Color	Test voltage (V)	Current (mA) ±10%	Power (W) ±10%	Luminous flux(LM) ±25%	Color temperature (K)	X,Y Coordinate/ Dominant wavelength	Light efficiency (LM/W)
	OTL-E10RIF/34V	E10	Warm White	34	12	0.3	3.7	2290	X:0.50-0.51 Y:0.42~0.43	12.3

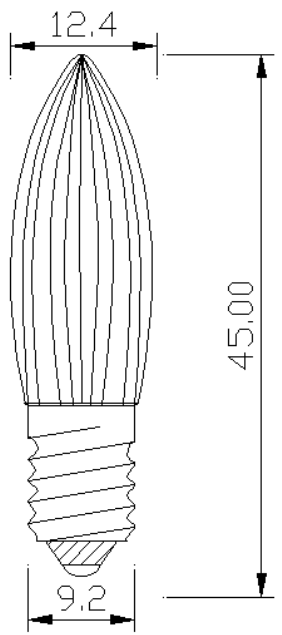

0° View

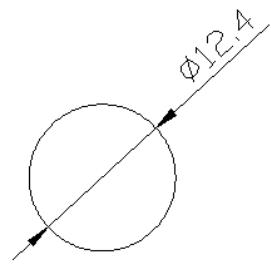

Top View

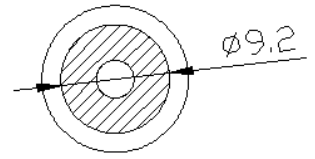

Upward View



OPTotech GmbH		
Specifications		
Date: 2018.02.02	Tab: QIU JUN	Admit: YE XUAN ZHI