

**SPECIFICATION:**

Current rating: 2.5 A  
 Voltage rating: 250 V  
 Insulation resistance: 1000 MΩ min.  
 Contact resistance: 10 mΩ max.  
 Dielectric voltage: 1000 V AC  
 Operation temperature: -25 °C to +85 °C

**MATERIAL:**

Housing: Nylon 66 beige UL94V-2  
 Contacts: Copper alloy

**FINISH:**

Contacts: Tin plated

**HANDLING:**

Packing: Bulk

**TOLERANCE:**

.X ± 0.20  
 .XX ± 0.15

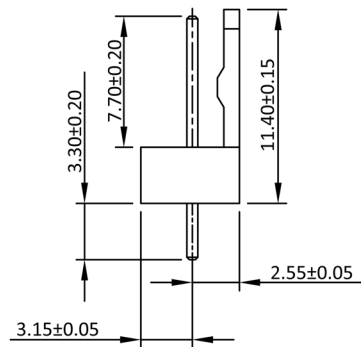
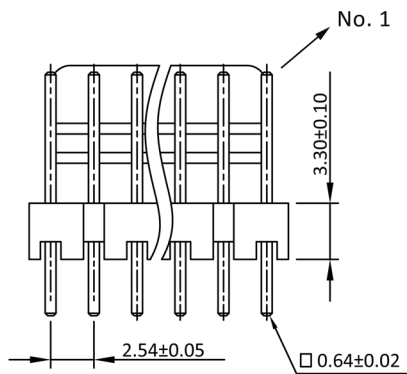
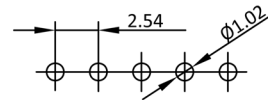
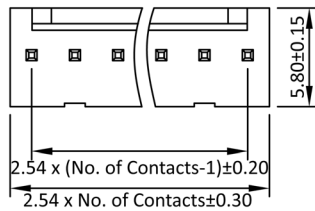
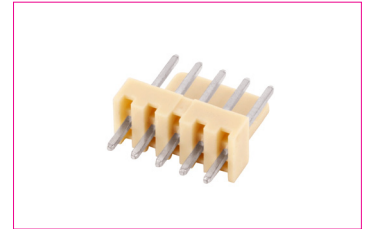

**Order-Information**

Identifier:	No. of contacts:	Version:
PSL	#	G
Wafer Series CV Pitch 2.54 mm single row	2: 1 x 2 3: 1 x 3 4: 1 x 4 : 20: 1 x 20	G: straight