

**Board-to-Wire Connectors  
Pitch 2.54 mm Series CV**

Housing CV Series single row



**SPECIFICATION:**

Current rating: 2.5 A  
 Voltage rating: 250 V  
 Insulation resistance: 1000 MΩ min.  
 Contact resistance: 10 mΩ max.  
 Dielectric voltage: 1000 V AC  
 Operation temperature: -25 °C to +85 °C

**MATERIAL:**

Housing: Nylon 66 beige UL94V-2

**HANDLING:**

Packing: Bulk

**TOLERANCE:**

.X ± 0.35  
 .XX ± 0.30

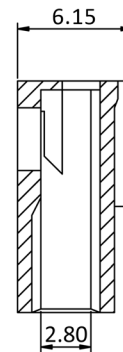
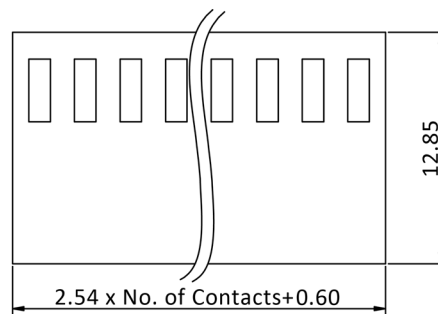
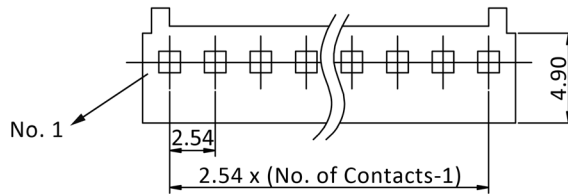
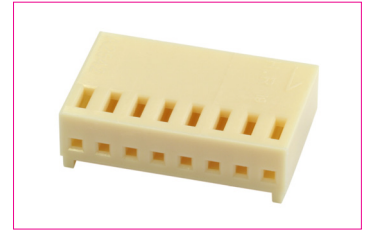

**Order-Information**

Identifier:	No. of contacts:
CV	#
Housing Series CV Pitch 2.54 mm single row	2: 1 x 2
	3: 1 x 3
	4: 1 x 4
	:
	20: 1 x 20