

YETDA FULL COLOR LED LAMP

Part Number	Chip			Lens Color	V _F (V) at I _F =20mA		I _v (mcd)			Viewing Angle 2θ 1/2 (deg.)
	Material	Emitter Color	λD(nm)		Typ.	Max.	at I _F =mA	Min.	Typ.	

5mm Hat Shape Full Color LED LAMP (Water Clear)

UNIT:mm

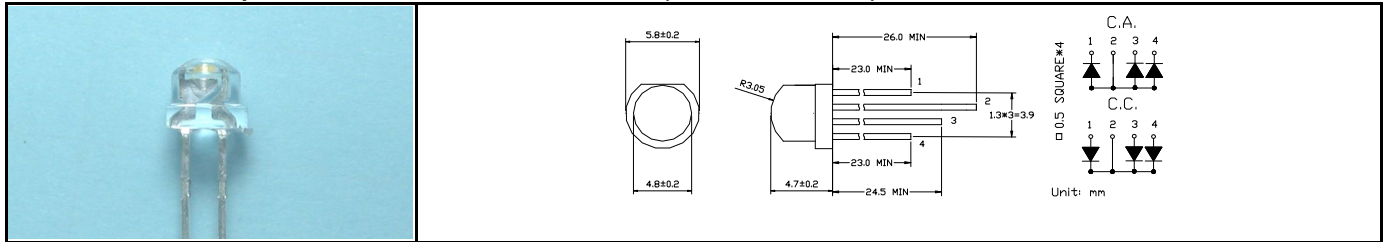

534RGB4E-CC	AlGaInP	Red	625	Water Clear	2.0	2.4	20	300	500	90
	InGaN	Pure Green	525		3.2	3.8		600	800	
	InGaN	Blue	470		3.2	3.8		400	600	
534RYGB4E-CC	AlGaInP	Red	625		2.0	2.4		300	500	
	AlGaInP	Yellow Green	573		2.0	2.4		200	300	
	InGaN	Blue	470		3.2	3.8		400	600	

10mm Full Color LED LAMP (Milky)

UNIT:mm

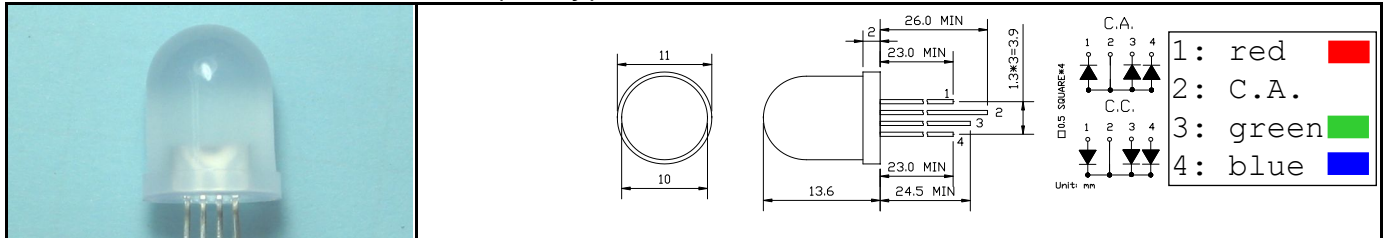

810RGB2E-CA	AlGaAs/GaAs	Red	660	Milky	1.8	2.0	20	700	1000	80
	InGaN	Pure Green	525		3.2	3.8		1100	1500	
	InGaN	Blue	470		3.2	3.8		700	1000	
810RYGB2E-CA	AlGaAs/GaAs	Red	660		1.8	2.0		700	1000	
	AlGaInP	Yellow Green	573		2.0	2.4		600	800	
	InGaN	Blue	470		3.2	3.8		700	1000	

10mm Full Color LED LAMP (Water Clear)

UNIT:mm

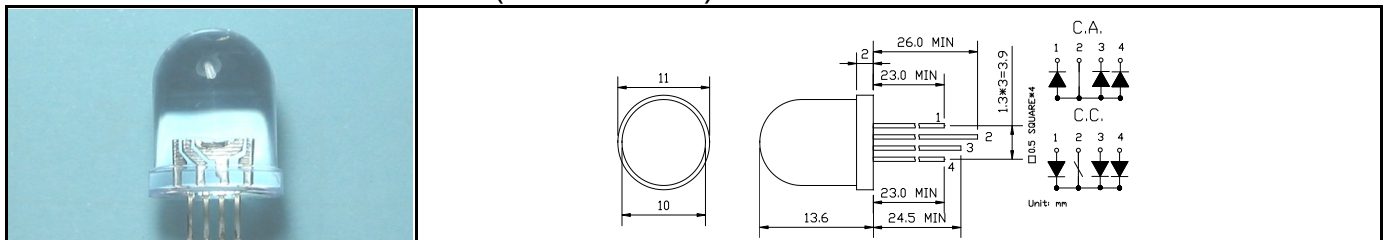

810RGB4E-CC	AlGaInP	Red	625	Water Clear	2.0	2.4	20	1400	2000	40
	InGaN	Pure Green	525		3.2	3.8		1800	2500	
	InGaN	Blue	470		3.2	3.8		1400	2000	
810RYGB4E-CC	AlGaInP	Red	625		2.0	2.4		1400	2000	
	AlGaInP	Yellow Green	573		2.0	2.4		1100	1500	
	InGaN	Blue	470		3.2	3.8		1400	2000	