

Specifications

Current Rate:3 AMP
 Insulation Resistance: $\geq 1000M\Omega$ at V=100V.
 Contact Resistance: $\leq 4m\Omega$ /Contact
 Dielectric voltage:1000V AC for one minute
 Operation Temperature:-40°C to +105°C

Material

Insulator:PPS(UL94V-0)
 Contact Pin:Copper Alloy

ORDER INFORMATION

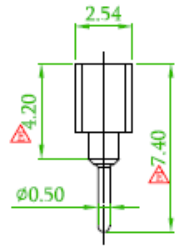
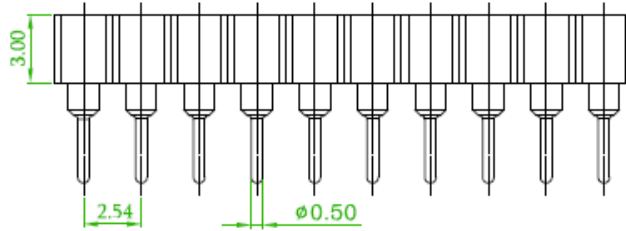
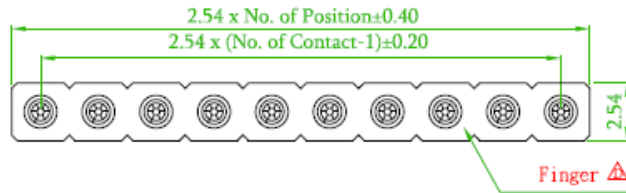
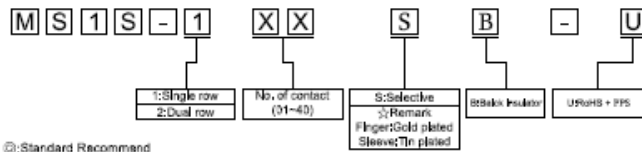

			Machine Pin 2,54mm					
E	△	Revised the Dim. :4.70→4.20, 7.43→7.40	品名 TITLE				日期 DATE	2008/08/26
D	△	Revised the drawing	品號 PART NO.	MS1S-1XX-U			繪圖 DRAWN	
C	△	Revised the plated option	圖號 DRAWING NO.	MS1S-1XX-U	版本 REV.	E	核對 CHECKED	
B	△	Revised the drawing	客戶品號 CUSTOMER P/N		比例 SCALE	FREE	核准 APPROVED	
AREA	REV.	DESCRIPTION	公差 TOLERANCE	X ±0.25 XX ±0.15	單位 UNIT	mm		
		DATE						