

RoHS COMPLIANT

REVISIONS				
REV	ECN NO.	DESCRIPTION	APPROVED BY	DATE
A				2006-06-03

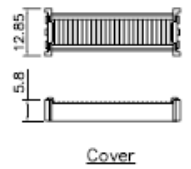
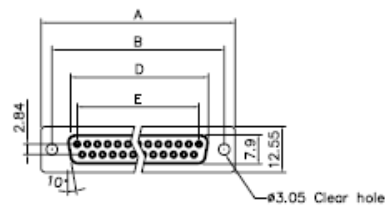

Cover

Product Specification

Material
 Insulator : Glass-Filled Thermoplastic PBT, UL94V-0
 Contact : Copper alloy
 Shell : SPCC

Electrical

Contact Resistance : 20 milliohms
 Max at 1 AMP DC.
 Insulation Resistance : 1000
 megohms at 500 VDC
 Dielectric Withstanding Voltage :
 1000 VAC/rms 60Hz For 1 minute
 Current Rating : 1 AMP
 Voltage Rating : 250 VAC/rms 60Hz

Important is that the min mating cycles d-sub
 must have one 1000

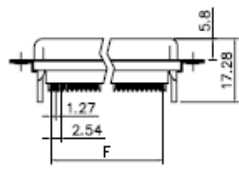

Without Insulator Support

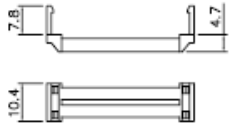
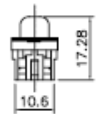

Strain Relief

Dimensions

Positions	A	B	D	E	F
9	30.81	24.99	16.33	11.08	10.16
15	39.14	33.32	24.66	19.39	17.78
25	53.04	47.04	38.38	33.24	30.48
37	69.32	63.50	54.64	49.86	45.72

DIMENSIONS:	
<input type="checkbox"/> mm	<input type="checkbox"/> INCH
<input type="checkbox"/> (ENCH)	<input checked="" type="checkbox"/> mm ONLY
UNLESS OTHERWISE SPECIFIED, GENERAL TOLERANCE:	
DECIMALS	ANGLES
.X ±0.25 (0.010)	X° ±3°
.XX ±0.25 (0.010)	X° ±1.0°
.XX ±0.13 (0.005)	
MATERIAL	THIRD ANGLE PROJECTION
FINISH	SCALE: 1 : 1
	SIZE: A3

TITLE	
103 SERIES D-SUB IDC TYPE	
DRAWING NO.	REV
103-XX2X2X021	A
FILE NO.	SHEET 1 OF 1

DO NOT SCALE DRAWING