

Circuit Diagram

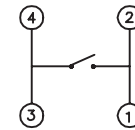

Mounting Holes

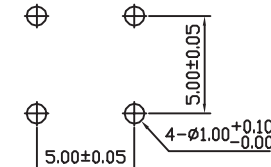

6	Cap	1
5	Dome	1
4	Contact Plate	1
3	Spring	1
2	Base	1
1	Terminal	2
NO	Name	Quantity

Specifications

Item	Criteria
Pre Travel	0.80 mmMax
Operating Force	1.30±50 gf
Ratings:	0.01A/35VDC
Contact Resistance:	50mΩ Max
Insulation Resistance:	100MΩMin
Operating Life :	100,000 cycles with load .
Dielectric:	500VAC(50~60HZ) - between non-connected terminals
	for one minute - between terminals and dead parts